

Coaxial Cable Assemblies

Flexible and Semi-Rigid Cable

Description

Maury 8015 series flexible cable assemblies feature improved cable to connector transitions. Nominal loss and power handling characteristics of the cable used in these assemblies is shown in the "Available Models" chart below.

Maury 8921 series semi-rigid cable assemblies are supplied as straight sections and are used in general purpose laboratory or systems applications where high stability and durability is critical.

Maury coaxial cable assemblies are available in the following standard lengths. Cable assemblies can also be fabricated to any length required. For non-standard length assemblies, please contact our Sales Department to place a special order. Both flexible and semi-rigid cable assemblies are available in four connector arrangements (see the Connector Configuration table below).

Available Models – Flexible Cable

| MODEL | FREQ. RANGE (GHz) & MAX. VSWR | TYPE | JACKET O.D. INCHES (CM) | MIN. BEND (r) INCHES (CM) | LOSS (dB) AT F _{MAX} |
|------------|--|-------|-------------------------|---------------------------|-------------------------------|
| 7915(X)(L) | DC – 50.0 ≤ 1.45 | 2.4mm | 0.40 (1.02) | 1.0 (2.54) | 0.65+1.43 dB/FT |
| 8015(X)(L) | DG – 26.5 ≤ 1.45 | 3.5mm | 0.20 (0.508) | 1.0 (2.54) | 0.40+0.50 dB/FT |
| 8926(X)(L) | DC – 12.4 ≤ 1.50 12.4 – 18.0 ≤ 1.75 | SMA | 0.19 (0.483) | 1.0 (2.54) | 0.85 dB/FT |

Note: When ordering, indicate the desired connector arrangement where (X) is shown (using "A" for female to female, "B" for male to male, or "C" for female to male configurations). Where (L) is shown indicate the desired standard line length from the chart below.



Available Models – Semi-Rigid Cable

| MODEL | FREQ. RANGE (GHz) & MAX. VSWR | TYPE | JACKET O.D. INCHES (CM) | MIN. BEND (r) INCHES (CM) | LOSS (dB) AT F _{MAX} |
|----------|-------------------------------|---------|-------------------------|---------------------------|-------------------------------|
| 8921A(L) | DC – 18.0 ≤ 1.30 | SMA F-F | 0.141 (0.356) | 0.25 (0.635) | 0.75 |
| 8921B(L) | DC – 26.5 ≤ 1.40 | SMA M-M | 0.141 (0.356) | 0.25 (0.635) | 0.75 |
| 8921C(L) | DC – 18.0 ≤ 1.30 | SMA F-M | 0.141 (0.356) | 0.25 (0.635) | 0.75 |

Note: When ordering, indicate the desired length (from the chart below) where (L) is shown.



Standard Line Lengths

| MODEL SUFFIX | LENGTH INCHES | LENGTH (CM) | MODEL SUFFIX | LENGTH INCHES | LENGTH (CM) | MODEL SUFFIX | LENGTH INCHES | LENGTH (CM) |
|--------------|---------------|-------------|--------------|---------------|-------------|--------------|---------------|-------------|
| 12 | 12.0 | (30.48) | 30 | 30.0 | (76.20) | 48 | 48.0 | (121.92) |
| 18 | 18.0 | (45.00) | 36 | 36.0 | (91.44) | 54 | 54.0 | (137.16) |
| 24 | 24.0 | (60.96) | 42 | 42.0 | (106.68) | 60 | 60.0 | (152.40) |

Precision Semi-Rigid Assemblies

Phase Matched 90° Bends



9526C

Description - Phase Matched 90° Bends

The Maury 7911A/B/C and 8011A1/B1/C1 series, and model 9526C are precision semi-rigid cable assemblies configured in a 90° bend. They provide a highly stable, extremely durable, low-loss, low VSWR right angle connection for 50 ohm test bench setups or other measurement applications. Each assembly consists of two Maury coaxitube connectors¹ joined by a standard length of copper-jacketed coaxitube that is formed to provide a precise right angle bend.

Three cable size/connector combinations are offered: 2.4mm with 0.0865-inch (O.D.) coaxitube; 3.5mm with 0.141-inch (O.D.) coaxitube; and 7mm with 0.250-inch (jacket O.D.) coaxitube.

Sexed connectors are offered in A (female to female), B (male to male), or C (female to male) connector arrangements.

Available Models

| MODEL | FREQUENCY RANGE (GHz) AND MAXIMUM VSWR | CONNECTOR ARRANGEMENT | "A" DIMENSION INCHES (CM) |
|--------|--|-----------------------|---------------------------|
| 8011A1 | DC – 26.5 ≤ 1.25 | 3.5mm F – F | 2.00 (5.08) |
| 8011B1 | DC – 26.5 ≤ 1.25 | 3.5mm M – M | 2.00 (5.08) |
| 8011C1 | DC – 26.5 ≤ 1.25 | 3.5mm F – M | 2.00 (5.08) |
| 9526C | DC – 8.0 ≤ 1.10 8.0 – 18.0 ≤ 1.25 | 7mm | 1.75 (4.45) |
| 7911A | DC – 50.0 ≤ 1.5 | 2.4mm F – F | 1.90 (4.83) |
| 7911B | DC – 50.0 ≤ 1.5 | 2.4mm M – M | 1.90 (4.83) |
| 7911C | DC – 50.0 ≤ 1.5 | 2.4mm F – M | 1.90 (4.83) |

Dimensions

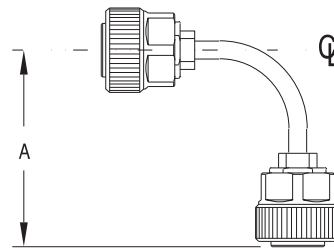

Precision Right Angle Test Port Adapters

Phase Matched 90° Bends

Description - Right Angle Test Port Adapters

The Maury 8011E1, 8011F1/F2 precision right angle test port adapters are designed to mate with the ruggedized test ports of Agilent and Anritsu network analyzers. They effectively extend the network analyzer test port at a right angle with the same ruggedized connector found on the test port, or with a standard 3.5mm female or male connector. They allow users to maintain the high reliability and stability of the network analyzer test port, with flexibility for unique measurement requirements.

Three connector combinations/types are offered: NMD 3.5mm (female) to NMD 3.5mm (male), NMD 3.5mm (female) to 3.5mm (female) and NMD 3.5mm (female) to 3.5mm (male).

These right angle test port adapters are ideal for use with the 8946 series of VNA test port cable/adaptor kits available from Maury (see page 134–136).

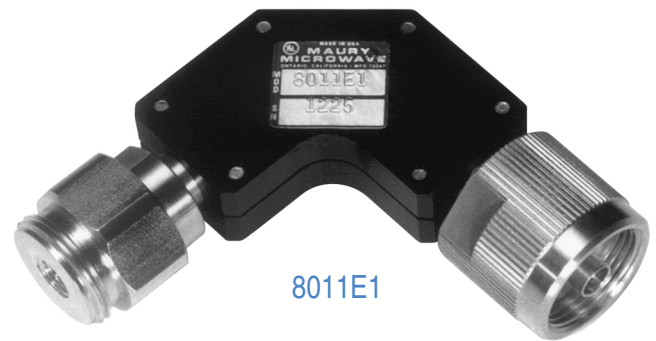

8011E1

Dimensions

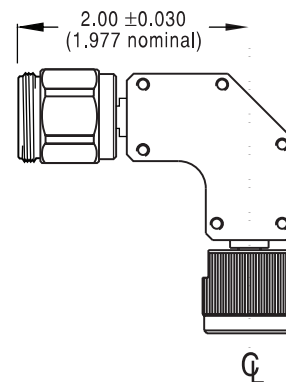

Available Models

| MODEL | FREQUENCY RANGE AND MAXIMUM VSWR | CONNECTOR ARRANGEMENT | DIMENSIONS INCHES (CM) |
|--------|----------------------------------|-------------------------|------------------------|
| 8011E1 | DC – 34.0 GHz ≤ 1.25 | NMD3.5mm F – NMD3.5mm M | 2.00 (5.08) |
| 8011F1 | DC – 34.0 GHz ≤ 1.25 | NMD3.5mm F – 3.5mm F | 2.00 (5.08) |
| 8011F2 | DC – 34.0 GHz ≤ 1.25 | NMD3.5mm F – 3.5mm M | 2.00 (5.08) |

¹ Maury coaxitube connectors are designed for use with 50 ohm copper-jacketed coaxitube, and are configured to allow the outer and center conductors to be soldered at assembly for maximum reliability.