

WAYS TO  
CONTROL  
TUNER



Telnet

Direct ASCII commands can be sent through raw TCP/IP interface over Ethernet or USB and used with any socket programming language or through any Telnet client program in any operating system.



MTUNE or ATS or IVCAD

Use Maury Microwave Software MTUNE or ATS or IVCAD to easily characterize and control your Tuner. All Software packages support all Maury Microwave tuner libraries.

XT Tuner  
Quick Start  
Guide



T  
I  
P  
S

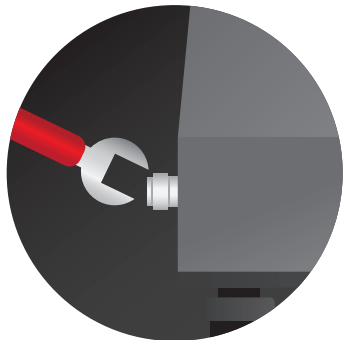

Use torque wrenches when  
tightening connectors  
Torque: 7mm / 12 lb-in — 3.5mm / 8 lb-in

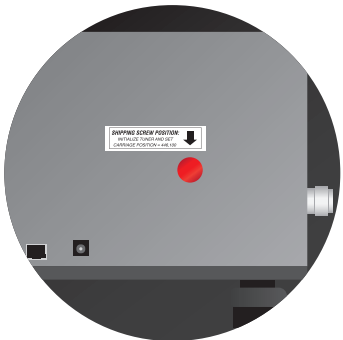

Always use locking screw  
during shipping/transport

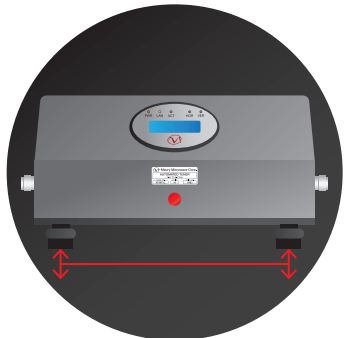

Tuner should be parallel to  
surface during operation

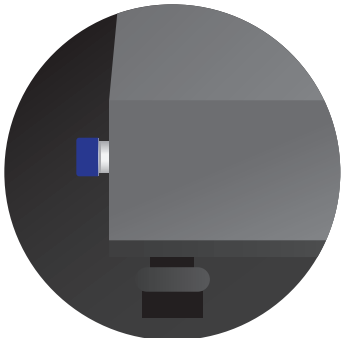

Use connector caps when  
tuner not in use



For more and detailed information about the XT tuners, please review data sheets 4T-050G06, 4T-050G07, 4T-050G08 and manual.

**CONTACT US:**  
W / maurymw.com E / maury@maurymw.com  
P / +1-909-987-4715 F / +1-909-987-1112  
2900 Inland Empire Blvd, Ontario, CA 91764



1D-001 — OCTOBER 2024

Maury Microwave

# Sec.1

## XT TUNER HANDLING

### Unpacking tuner and what's inside box

- › Tuner
- › Power supply
- › USB cable
- › Ethernet cable
- › USB to Ethernet adapter
- › Manuals



All items listed previously will be packed in the same box.

Do not throw away the packaging, you will need it later to transport the tuner

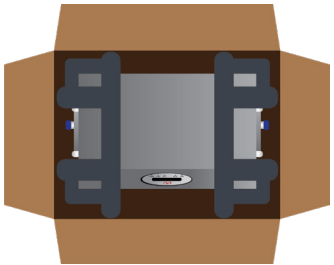

Once you open box, you will find the tuner packaged between 2 foam inserts which protect it while it's transported.

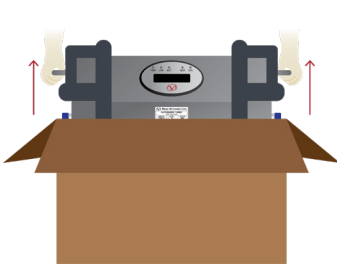

In order to remove tuner from box, grab the handles on each side and pull upwards.

Note: It is recommended that 2 people unpack tuner.

### Getting to know the tuner

1. Locking screw location during normal use (storage)
2. LCD/Main Display
3. Reset button
4. USB port
5. Ethernet port
6. Power supply port
7. Locking screw location during shipping/transport
8. Connector
9. Connector caps (install when tuner is not in use or during shipping)

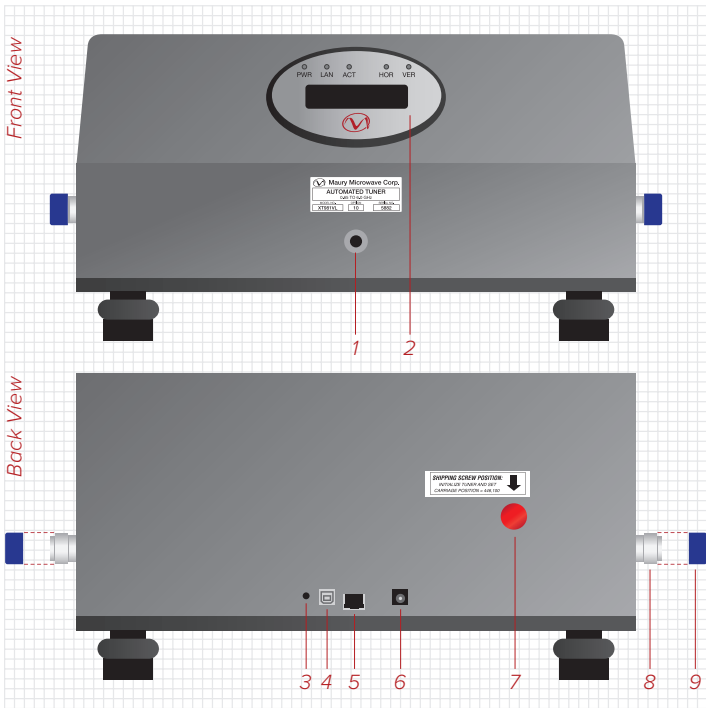

### Repacking your tuner for shipping/transport



Place connector caps back and make sure locking screw is in the correct location as shown in image. Note: Refer to manual for moving carriage to locking position (probes should be positioned half way between lower and upper limits).



Place foam inserts back as shown in image.

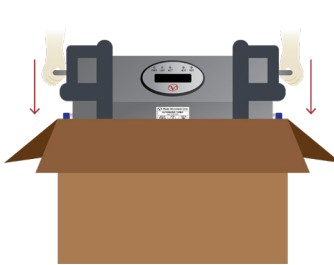

Grab tuner from side handles and place back into box.

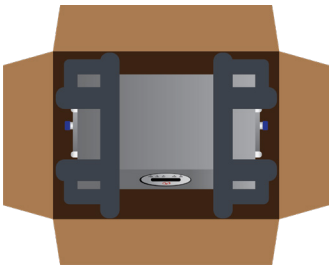

Make sure all items have been placed back into box.

# Sec.2

## SETTING UP YOUR TUNER FOR FIRST USE

### USB Setup

Note: Only use USB or Ethernet, but not both at same time.

1. Connect USB cable between tuner and computer
2. Plug in power supply to tuner first (only use power supply that was supplied with tuner, failure to do so may result in damage and void warranty)
3. Plug in power supply to wall
4. Tuner will boot up at this time
5. Pop-up window to update USB driver if first time
6. Identify USB port number in Windows

Note: Please refer to XT Tuner user manual for more information.

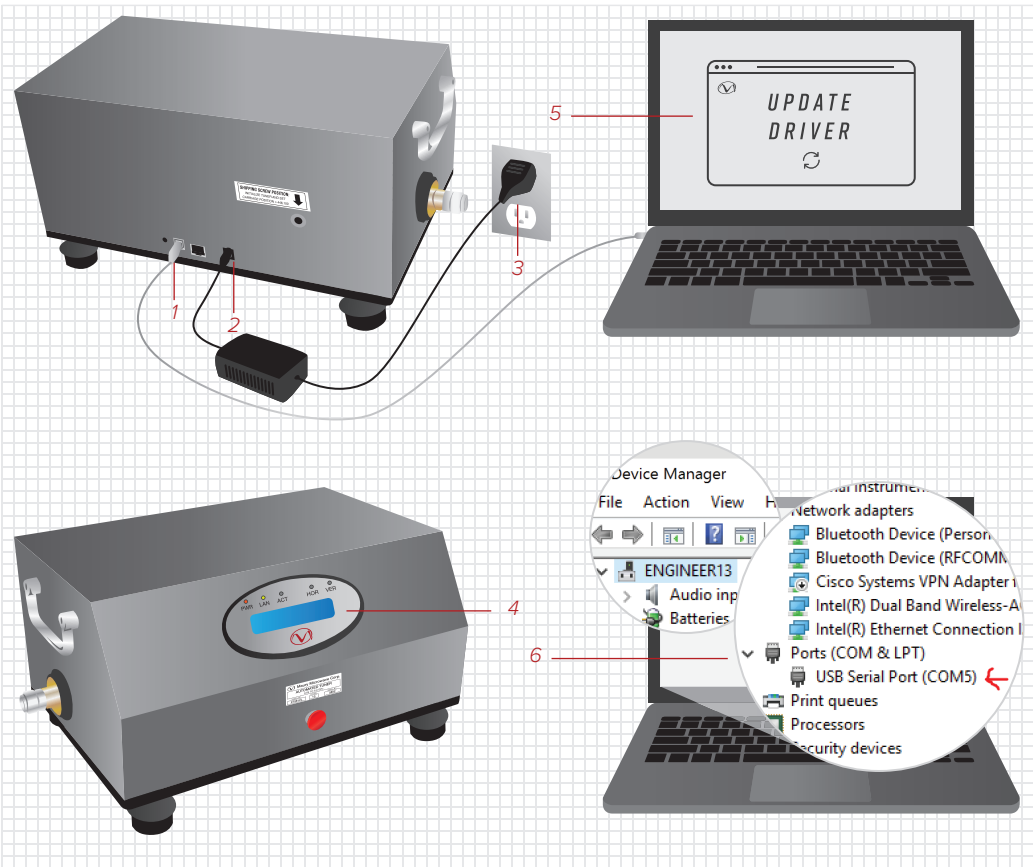

### Ethernet Setup

Note: Only use USB or Ethernet, but not both at same time.

1. Connect Ethernet cable between tuner and computer
2. Plug in power supply to tuner first (only use power supply that was supplied with tuner, failure to do so may result in damage and void warranty)
3. Plug in power supply to wall
4. Tuner will boot up at this time
5. Configure Ethernet card and IP address on computer

Note: Please refer to XT Tuner user manual for more information.

